

# Anel Elástico

## Modelo EXTERNO/INTERNO

### Anel elástico tipo E

Aplicação: para eixos com diâmetro entre 4 e 1000 mm.  
Trabalha externamente - Norma DIN 471

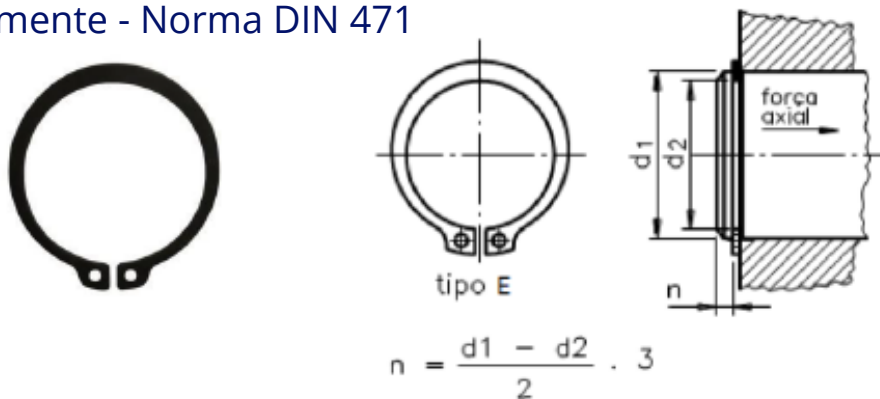

### Anel elástico tipo I

Aplicação: para furos com diâmetro entre 9,5 e 1000 mm.  
Trabalha internamente - Norma DIN 472

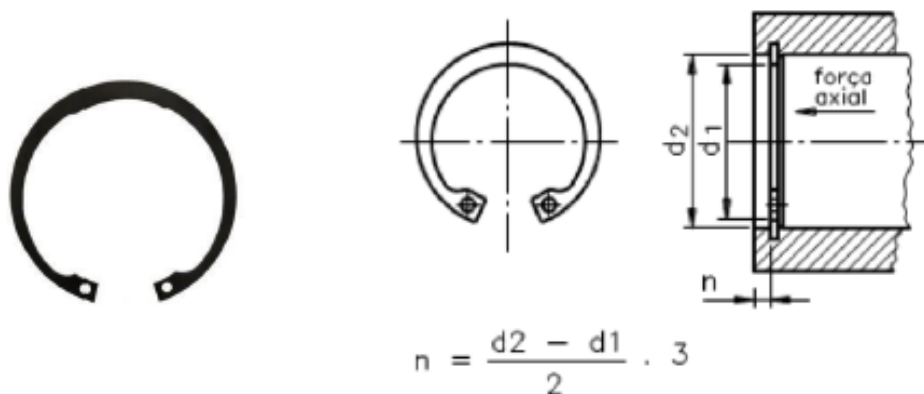

**FIXOTRAVAS**

DESDE 2005

Peças e Acessórios Industriais

# Anel Elástico

## DIN 6799



### Modelo RS

DIN 6799			ANEL				RANHURA			DADOS COMPLEMENTARES					
CÓDIGO	d1 (mín)	d1 (máx)	d3 (máx)	e	d4	peso (g)	d2	Tol.	m	d4 (mont)	n (mín)	Pn (mín) kgf	Pn (máx) kgf	g (máx)	n adm (rpm)
AERS 1,2	1,4	2,0	1,2	0,3	2,90	0,009	1,2	-0,06	0,34	3,0	0,6	2,0	10,0	0,4	47.000
AERS 1,5	2,0	2,5	1,5	0,4	3,90	0,021	1,5	-0,06	0,44	4,0	0,8	6,8	15,7	0,6	42.000
AERS 1,9	2,5	3,0	1,9	0,5	4,40	0,040	1,9	-0,06	0,54	4,5	1,0	10,5	20,7	0,7	40.000
AERS 2,3	3,0	4,0	2,3	0,6	5,90	0,069	2,3	-0,06	0,64	6,0	1,0	14,6	42,0	0,9	38.000
AERS 3,2	4,0	5,0	3,2	0,6	6,90	0,088	3,2	-0,75	0,64	7,0	1,0	22,7	58,0	0,9	35.000
AERS 4,0	5,0	7,0	4,0	0,7	8,85	0,158	4,0	-0,75	0,74	9,0	1,2	35,3	95,0	1,0	32.000
AERS 5,0	6,0	8,0	5,0	0,7	10,85	0,236	5,0	-0,75	0,74	11,0	1,2	43,0	115,0	1,0	28.000
AERS 6,0	7,0	9,0	6,0	0,7	11,80	0,255	6,0	-0,75	0,74	12,0	1,2	51,0	135,0	1,1	25.000
AERS 7,0	8,0	11,0	7,0	0,9	13,80	0,474	7,0	-0,9	0,94	14,0	1,5	59,0	200,0	1,3	22.000
AERS 8,0	9,0	12,0	8,0	1,0	15,75	0,660	8,0	-0,9	1,05	16,0	1,8	66,8	250,0	1,5	20.000
AERS 9,0	10,0	14,0	9,0	1,1	18,20	1,000	9,0	-0,11	1,15	18,5	2,0	75,0	300,0	1,6	17.000
AERS 10	11,0	15,0	10,0	1,2	19,70	1,120	10,0	-0,11	1,25	20,0	2,0	82,0	350,0	1,8	15.000
AERS 12	13,0	18,0	12,0	1,3	22,70	1,770	12,0	-0,11	1,35	23,0	2,5	98,0	465,0	1,9	13.000
AERS 15	16,0	24,0	15,0	1,5	28,70	3,370	15,0	-0,13	1,55	29,0	3,0	122,0	660,0	2,2	11.000
AERS 19	20,0	31,0	19,0	1,75	36,70	6,420	19,0	-0,13	1,80	37,2	3,5	157,0	845,0	2,5	7.600

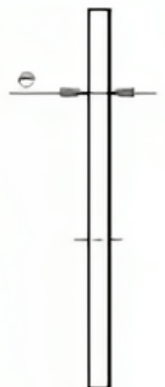
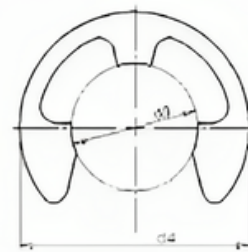
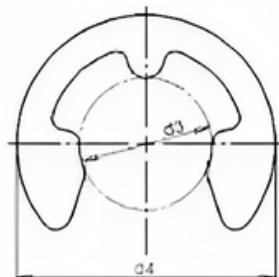
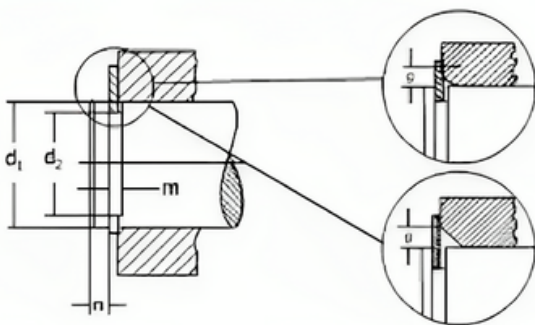

**FIXOTRAVAS**

DESDE 2005

Peças e Acessórios Industriais